

INFORMATION

This drawing is the property of C4 Projects and is not to be copied, reproduced or used in any way without the written consent of C4 Projects. The original shall have no responsibility for any loss or damage to the original or any copies thereof. The drawing shall be used in accordance with the terms and conditions of the contract. All dimensions shall be checked on site by the contractor prior to proceeding with any work. The contractor shall be liable to ensure that any dimensions are in accordance with the drawing.

DISCLAIMER
This drawing is based on CAD files provided by the client. C4 Projects does not accept liability for any loss or damage to the original or any copies thereof. The contractor shall be liable to ensure that any dimensions are in accordance with the drawing.

SOFTWARE USED
C4 Projects used Revit 2021 for the design. Autodesk AutoCAD Architecture 2021 for the drawing. All dimensions are in millimeters unless otherwise stated.

Hazard Identification	
ref	date
Racking Schedule Option 1	
Type Mark	Start
Created By: Racking-100 / 21/04/2022	DK

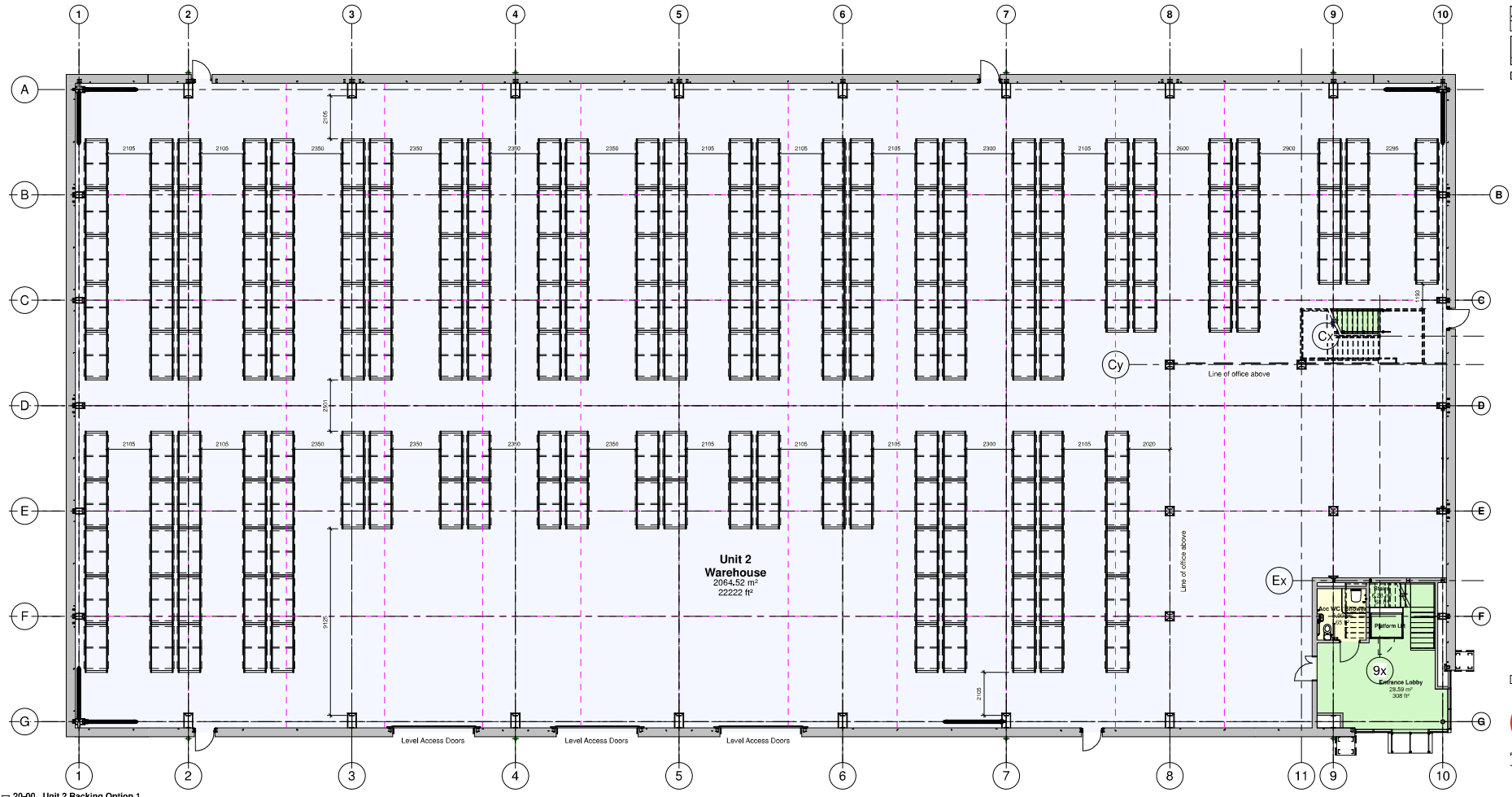

001	Final Issue	EK	21.04.2022	CH
Filter: Revision Details				
	Drawn	Check	Checked	

C4 Projects
 100, Riverside Way, Riverside, Walsley, West Yorkshire, WF4 13LW
 Tel: 01924 721 100
 Email: info@projects.c4.uk
 www.projects.c4.uk

Client: Total Developments (NW) Ltd

Project: Drake House Site
 Sheffield

Drawing Title: Unit 2 Racking Layout Option 1

Status: Purpose of Issue	
S2 SUITABLE FOR INFORMATION	
Drawn by: EK	Created: 21.04.2022
C4 Job no: 20031	Scale: 1:100 @ A1
Drawn by: EK	Checked: DK
20031-C4P-B2-00-DR-A-2002	Rev: C01

Drawing Status

INFORMATION

This drawing is the property of C4 Projects and is not to be copied, reproduced or used in any way without the prior written consent of C4 Projects.

The contractor shall have no responsibility for any errors, omissions, or inaccuracies in this drawing, and shall be responsible for any errors, omissions, or inaccuracies in any information provided to C4 Projects.

The drawing shall be used in accordance with all other drawings and specifications issued by C4 Projects. Any discrepancies shall be resolved by C4 Projects.

All dimensions are to be checked on site by the contractor prior to proceeding with any work. The contractor shall be liable to ascertain any dimensions work is to be carried out on.

DISCLAIMER

This drawing is based on CAD. It is an uncontrolled document and should not be used for construction purposes. It is intended for use as a guide only and should not be used for construction purposes. It is not intended to be used for construction purposes.

SOFTWARE USED

Autodesk Revit 2021.0

SOFTWARE DEVELOPER

C4 Projects Limited, 100, The Quadrant, Sheffield, S1 2TA, UK

CAUTION

This drawing is not to be used for construction purposes. It is intended for use as a guide only and should not be used for construction purposes. It is not intended to be used for construction purposes.

Hazard Identification

ref	hazard	date

Racking Schedule Option 2	
Type/Task	Count
Storebay by substation	10

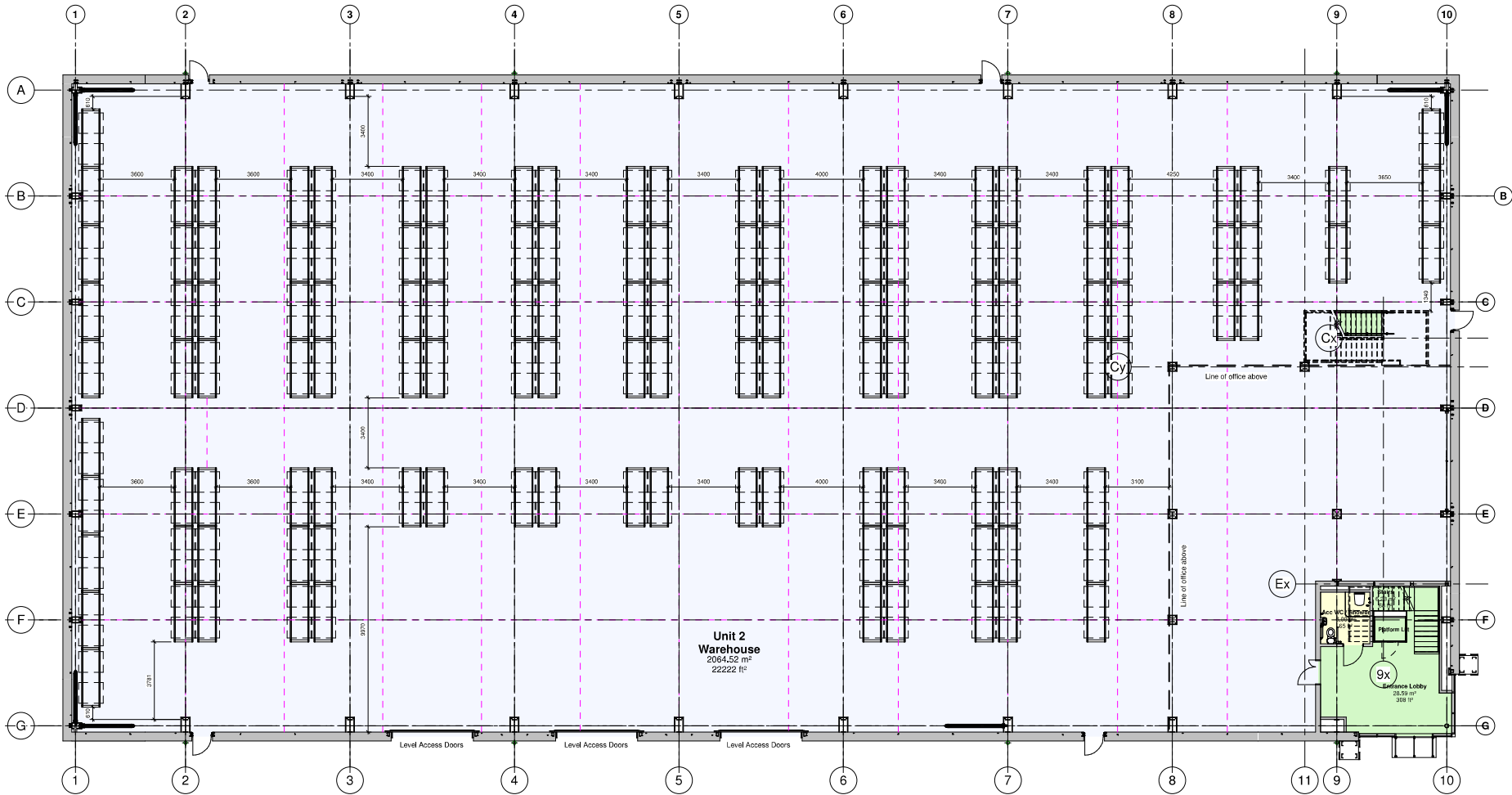

20-00 Unit 2 Racking Option 2
1:100

001	Final Issue	EK	21.04.2022	CH
Rev	Revision Details	Drawn	Check	Checked

C4 Projects

Company:
100, The Quadrant,
Sheffield, S1 2TA,
UK
t: 0114 271 1300
e: info@c4projects.co.uk
www.c4projects.co.uk

Project Managers: Architecture - Building Surveying - Cost Consultancy

Client:
Total Developments (NW) Ltd

Project:
Crake House Site
Sheffield

Drawing Title:
Unit 2 Racking Layout Option 2

Status: Purpose of Issue
S2 SUITABLE FOR INFORMATION

Drawn by: EK Created: 21.04.2022

C4 Job no: 20031 Scale: 1:100 @ A1

Disc no: 20031-C4P-B2-00-DR-A-2003 Rev: C01